

1. The **dimension lines** are **outside** the object.

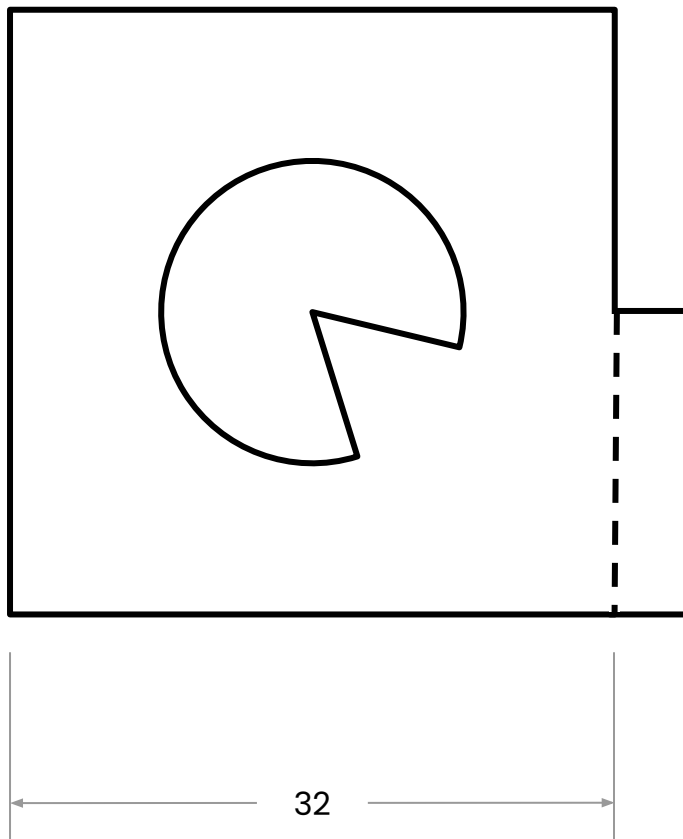

2. The **extension lines** are **perpendicular** to the **dimension lines** and start **2 mm away** from the side of the object. They extend **2 mm beyond** the ends of the dimension lines.

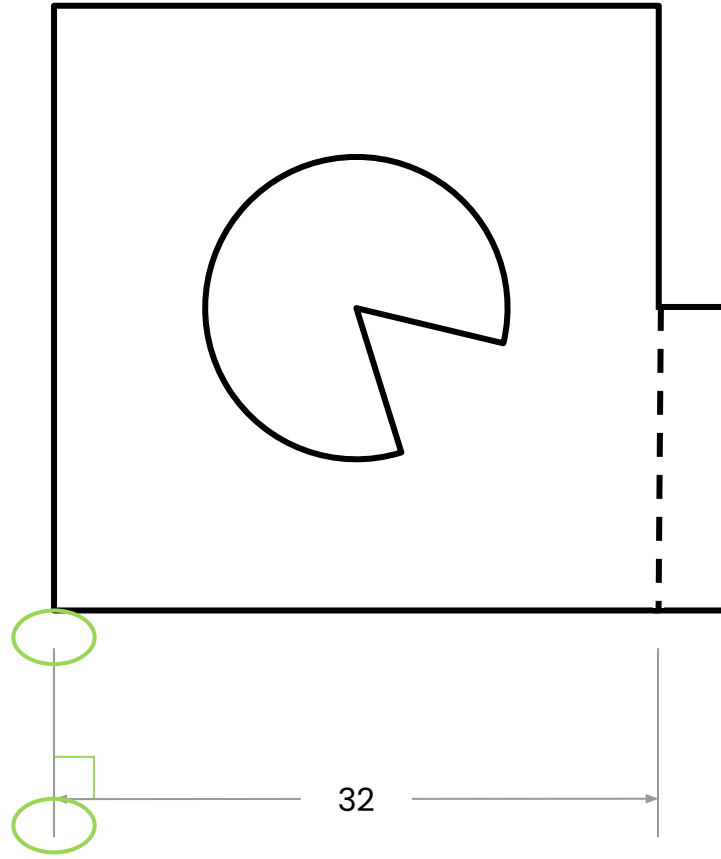

3. There is a gap of **at least 10 mm** between the side of an object and the dimension lines or between two dimension lines.

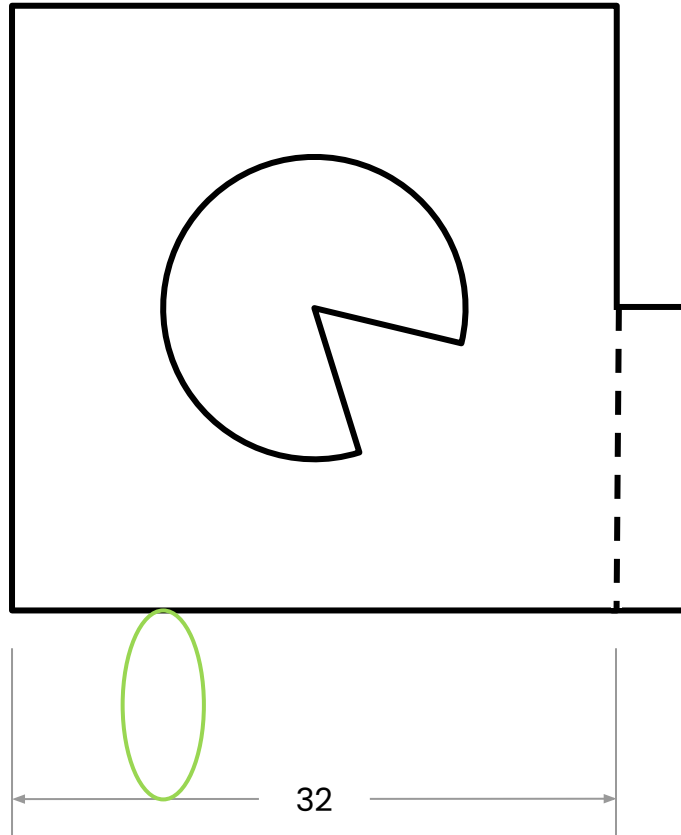

4. A **centre line** can be used as an **extension line** if it extends beyond the outlines of the object.

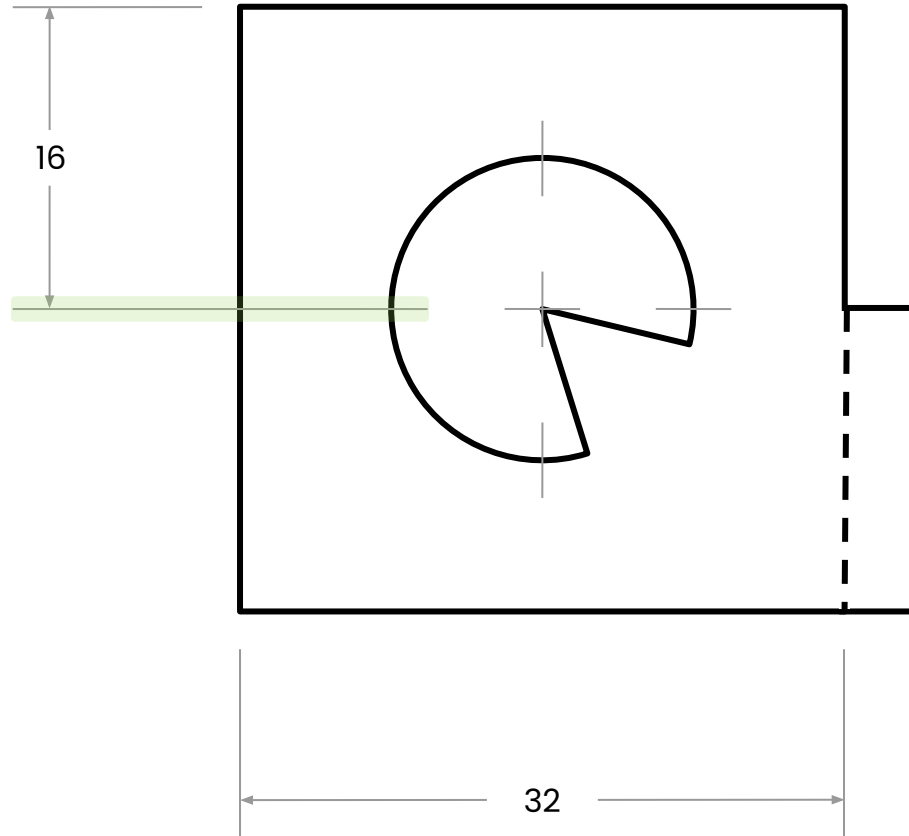

5. A single **extension** line can be used for **more than one** dimension.

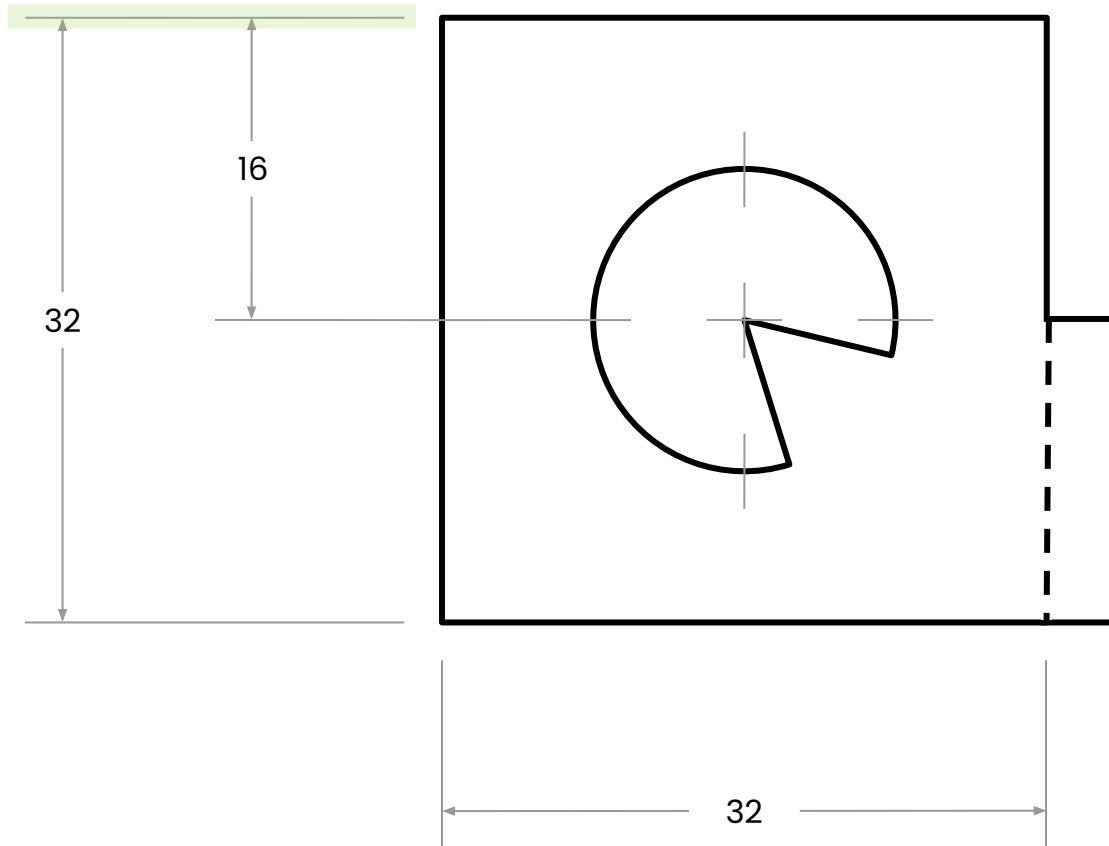

6. Shorter dimension lines go in front of longer ones, closer to the side of the object.

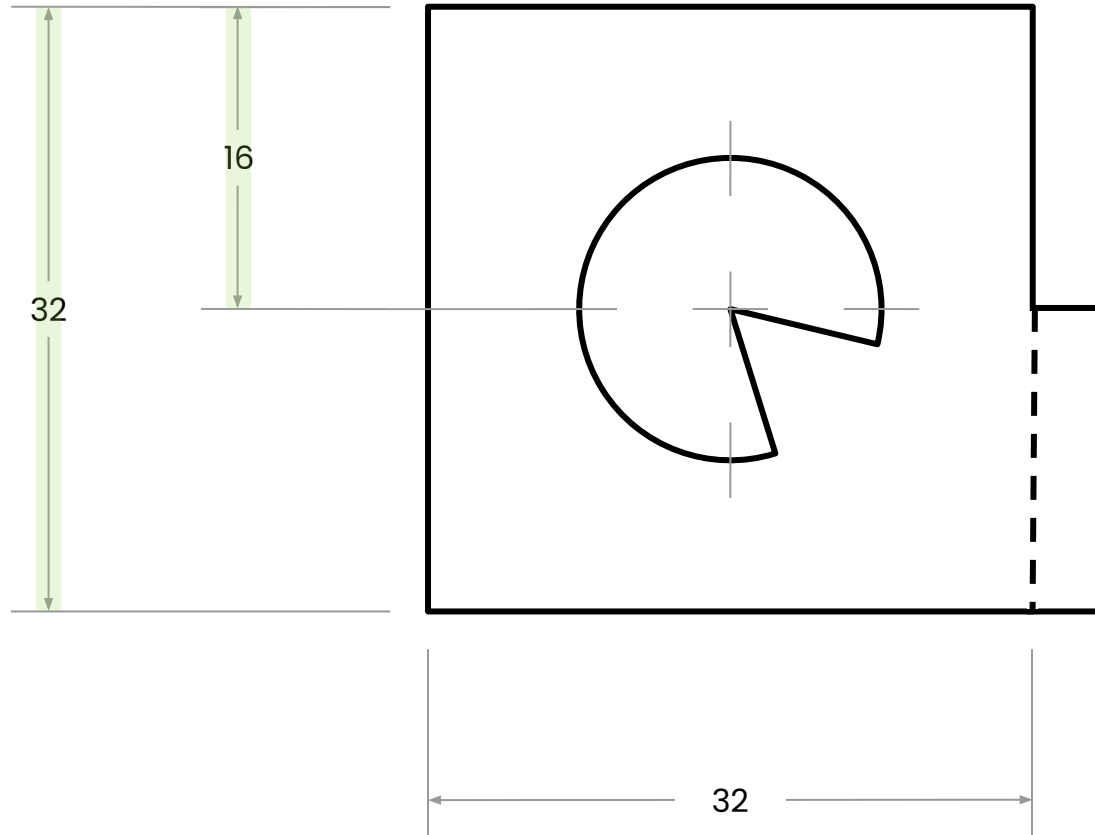

7. If the space between the extension lines is too small, the **arrows** go on the **outside**. The **dimension** can go **inside** or **outside** the extension lines, depending on how much space there is.

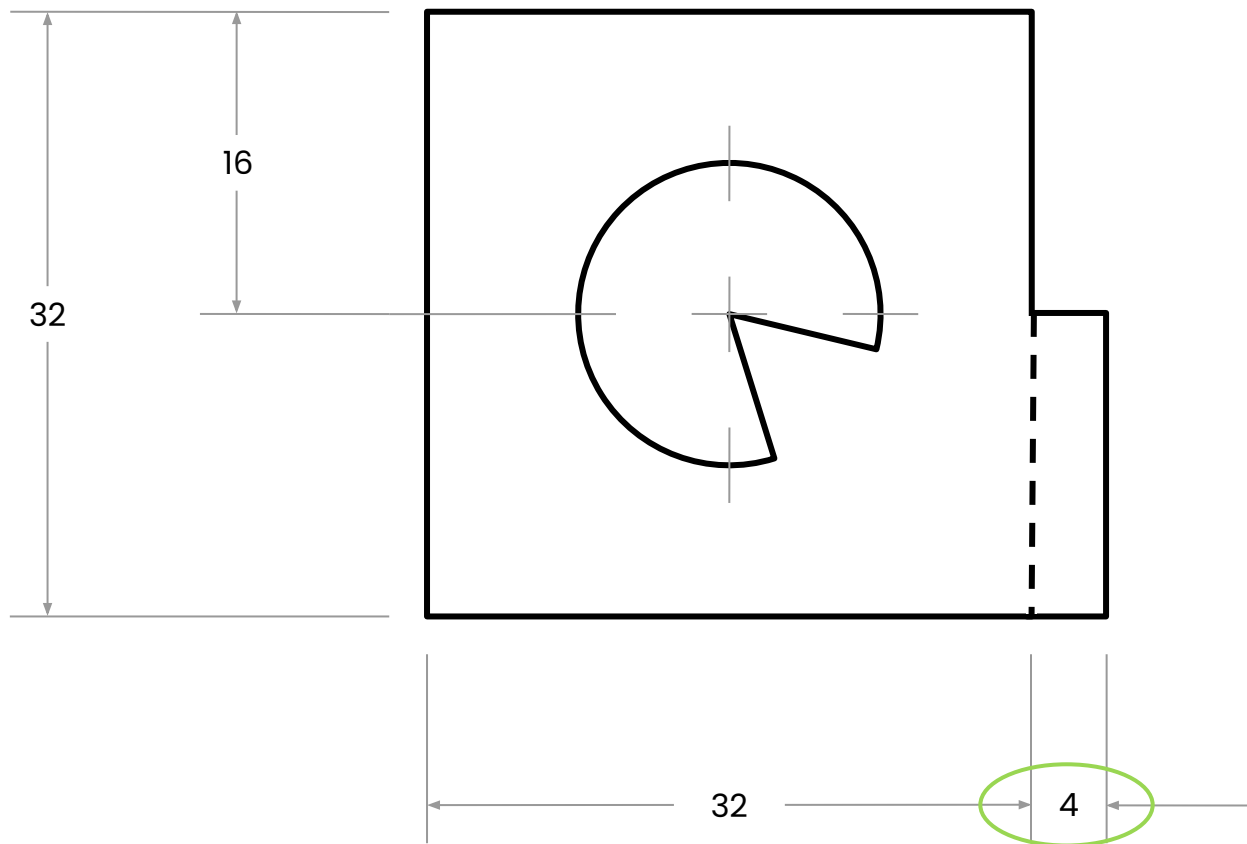

8. The leader lines are drawn at an angle of 45° and point toward the centre of a circle.

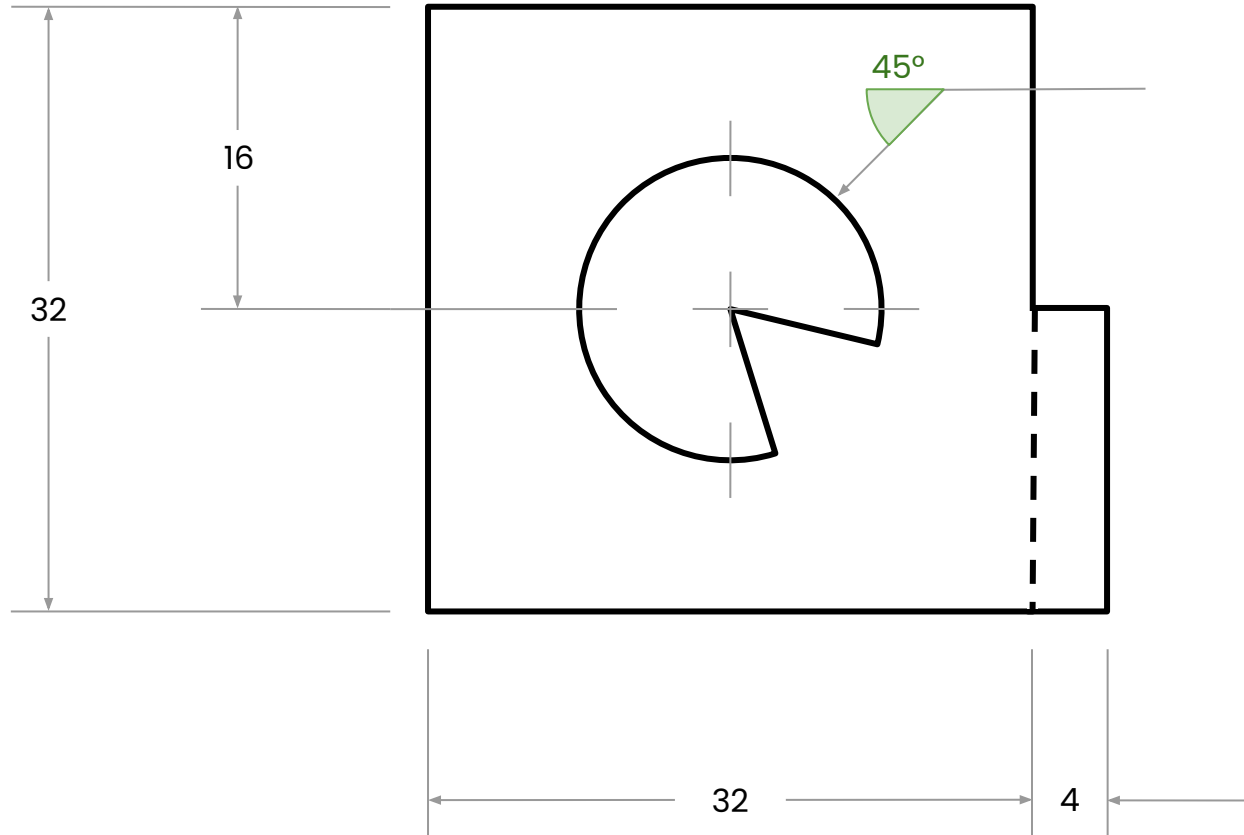

9. Dimensions used to identify the **radius** of a circle are preceded by an **R**. They are preceded by the symbol \varnothing or the letters **DIA** when they indicate the diameter.

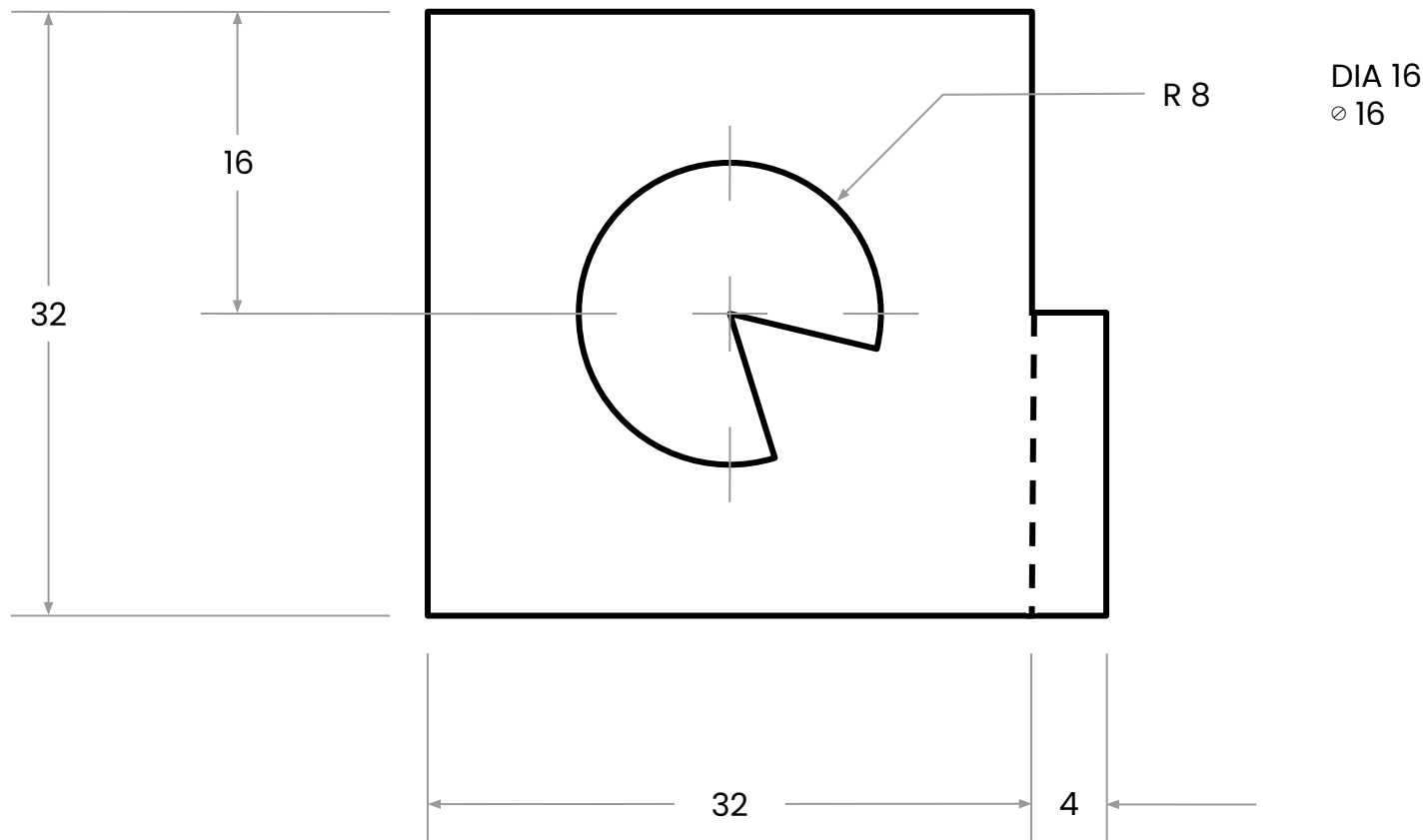

10. The dimension lines of angles are **curved**.

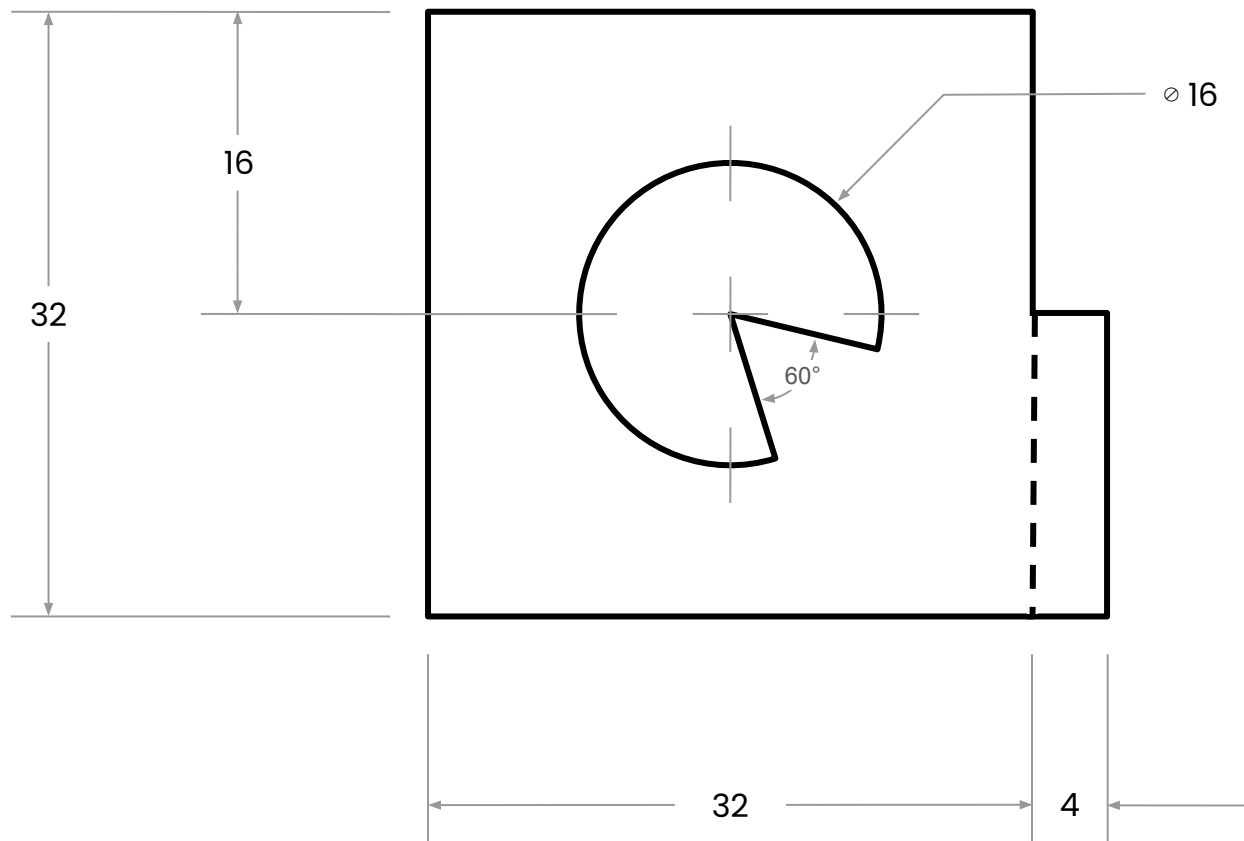

Final Drawing

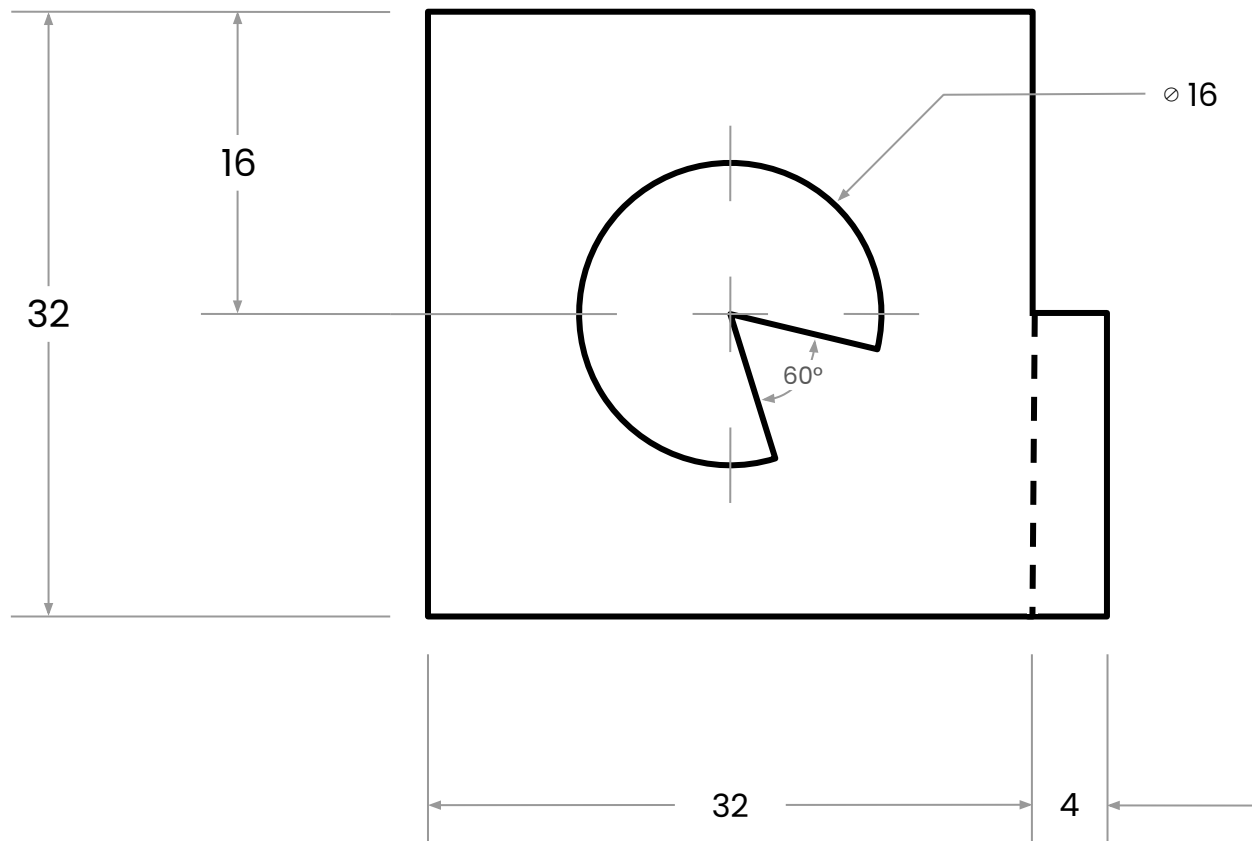

Dimensioning Rules

1. The dimension lines are outside the object.
2. The extension lines are perpendicular to the dimension lines and start 2 mm away from the side of the object. They extend 2 mm beyond the ends of the dimension lines.
3. There is a gap of at least 10 mm between the side of an object and the dimension lines or between two dimension lines.
4. A centre line can be used as an extension line if it extends beyond the outlines of the object.
5. A single extension line can be used for more than one dimension.
6. Shorter dimension lines go in front of longer ones, closer to the side of the object.
7. If the space between the extension lines is too small, the arrows go on the outside. The dimension can go inside or outside the extension lines, depending on how much space there is.
8. The leader lines are drawn at an angle of 45° and point toward the centre of circles.
9. Dimensions used to identify the radius of a circle are preceded by an R. They are preceded by the symbol \varnothing or the letters DIA when they indicate the diameter.
10. The dimension lines of angles are curved.